

REVISION HISTORY

REV	DESCRIPTION	DATE	EO NUMBER
A	Initial Release	10/9/2018	XXXXXXXXXXXX
B	Add sensor axis location	7/2/2019	XXXXXXXXXXXX

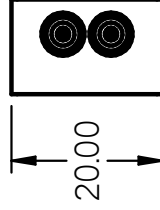
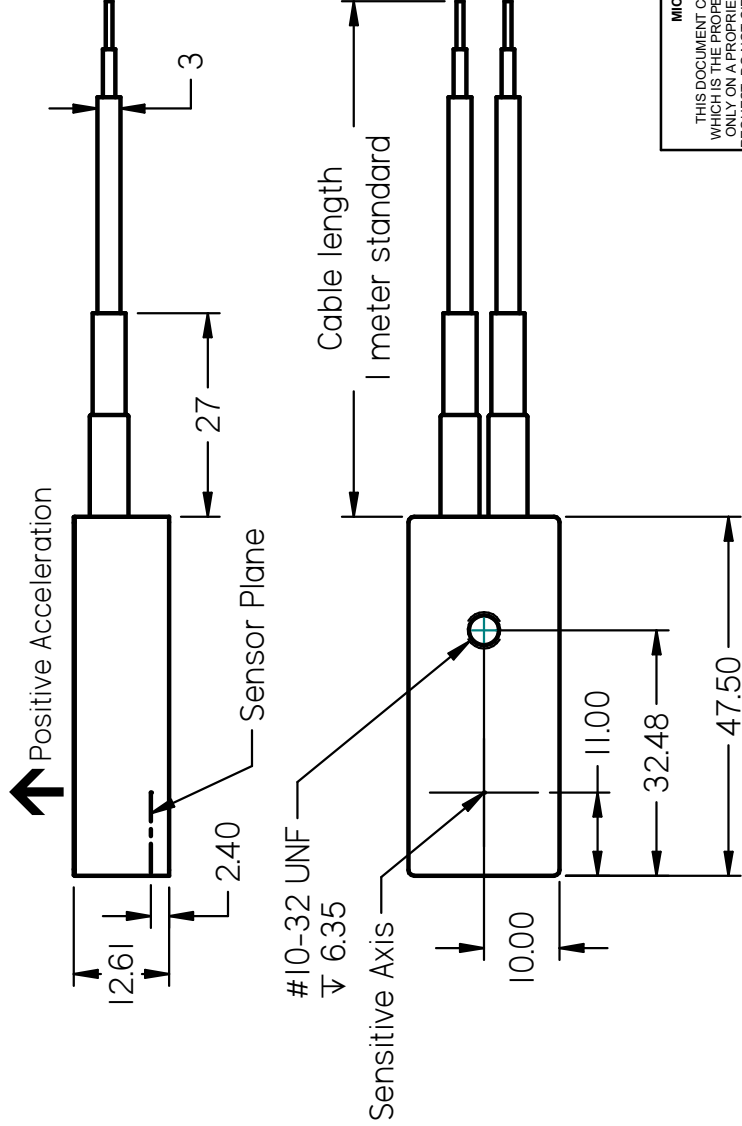
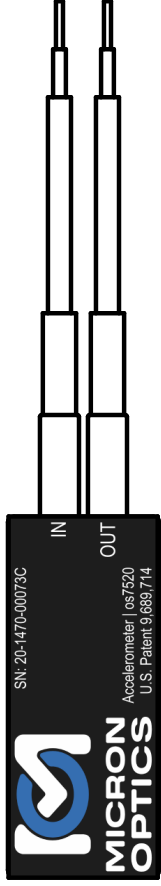
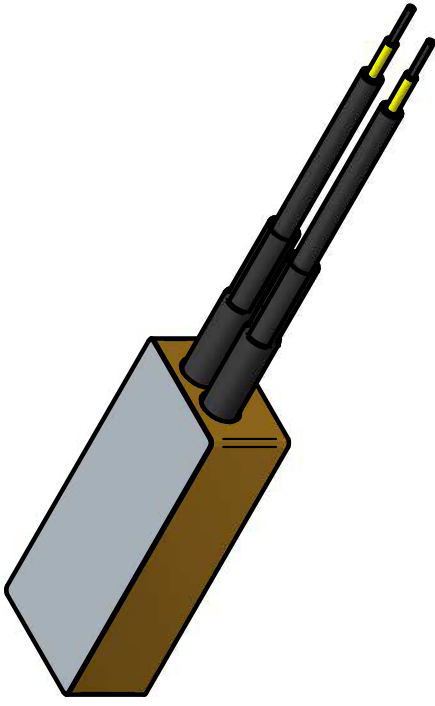

MICRON OPTICS PROPRIETARY
 THIS DOCUMENT CONTAINS MATERIAL AND/OR INFORMATION WHICH IS THE PROPERTY OF MICRON OPTICS, INC. IT IS SUPPLIED ONLY ON A PROPRIETARY BASIS, AND MUST BE RETURNED UPON REQUEST. DO NOT CIRCULATE, REPRODUCE OR DIVULGE TO OTHER PARTIES WITHOUT WRITTEN CONSENT OF MICRON OPTICS, INC.

DIMENSIONS IN MILLIMETERS
 INTERPRET DRAWINGS PER ANSI Y14.5 - 2009

GENERAL TOLERANCE UNLESS OTHERWISE SPECIFIED
 DECIMAL MM X = ±0.15, Y = ±0.25, Z, XX = ±0.15
 ANGLES = ±0.5°
 MACHINED SURFACES = 1.6um

<p>MICRON OPTICS Accelerometer os7520 Customer Drawing</p>		PART NO	DRAWING NO
		740-400003	740-400003
DRN BY	STEVE F.	SIZE	A
			SHEET 1 OF 1